

**PLAN REFERENCES:**

- 1.) "CERTIFIED PLOT PLAN FOR GEORGE GAUTHIER TAX MAP 103, LOT 38 LONG SHORES DRIVE BARRINGTON, N.H." BY: BERRY SURVEYING & ENGINEERING DATED: OCTOBER 6, 2006 FILE NO.: DB 2006-167
- 2.) "LONG SHORES BARRINGTON, N.H. EASTERLY END OF NORTH SHORE DEVELOPED BY: LONG SHORES, INC. ONE COURT STREET BOSTON, MASS." BY: THE BERRY CONSTRUCTION CO., INC. DATED: JULY 26, 1965 S.C.R.D.: PLAN #41, POCKET #4 FOLDER #1 FILE NO.: DB 1965-20
- 3.) "LONG SHORES BARRINGTON, N.H. EASTERLY END OF NORTH SHORE DEVELOPED BY: LONG SHORES, INC. ONE COURT STREET BOSTON, MASS." BY: THE BERRY CONSTRUCTION CO., INC. DATED: JULY 26, 1965 S.C.R.D.: PLAN #47C, POCKET #4 FOLDER #1 FILE NO.: DB 1965-20

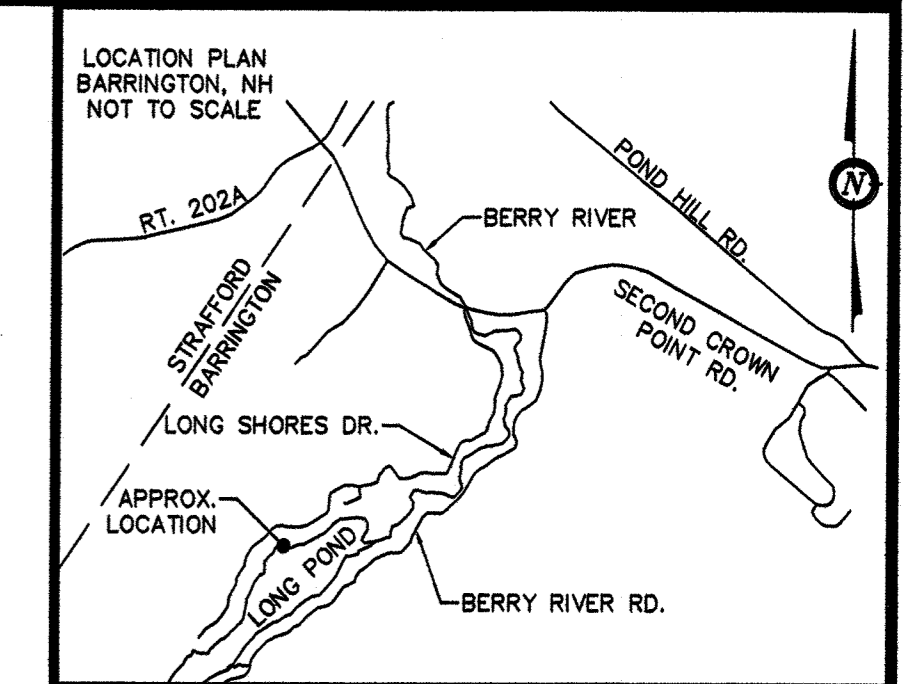

**NOTES:**

- 1.) OWNER: TAMMY L. ROBBINS 10 FALKLAND LANE ROCHESTER, NH 03867
- 2.) TAX MAP 103, LOT 38
- 3.) LOT AREA: 12,539 Sq. Ft.±, 0.29 Ac.±
- 4.) S.C.R.D. BOOK 4784, PAGE 554
- 5.) THE INTENT OF THIS PLAN IS TO SHOW THE LOCATION OF BOUNDARIES OF TAX MAP 103, LOT 38 IN ACCORDANCE WITH AND IN RELATION TO THE CURRENT AND ORIGINAL LEGAL DESCRIPTIONS, AND IS NOT AN ATTEMPT TO DEFINE UNWRITTEN RIGHTS, DETERMINE THE EXTENT OF OWNERSHIP, OR DEFINE THE LIMITS OF TITLE.
- 6.) NH STANDARD PROPERTY SURVEY WITH A CLOSURE BETTER THAN 1:10,000.

**LEGEND:**

- 3/4" REBAR W/ ID CAP ~SET~
  - STEEL STAKE ~FND~
  - REBAR ~FND~
  - UTILITY POLE
  - GUY WIRE
  - SURVEY TIE LINE
  - - - APPROX. ABUTTING LOT LINES
  - - - OVERHEAD UTILITIES
  - FND
  - OHU
- S.C.R.D. STRAFFORD COUNTY REGISTRY OF DEEDS

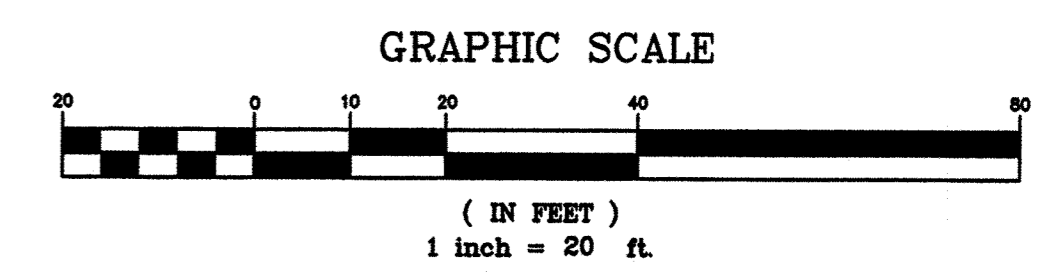
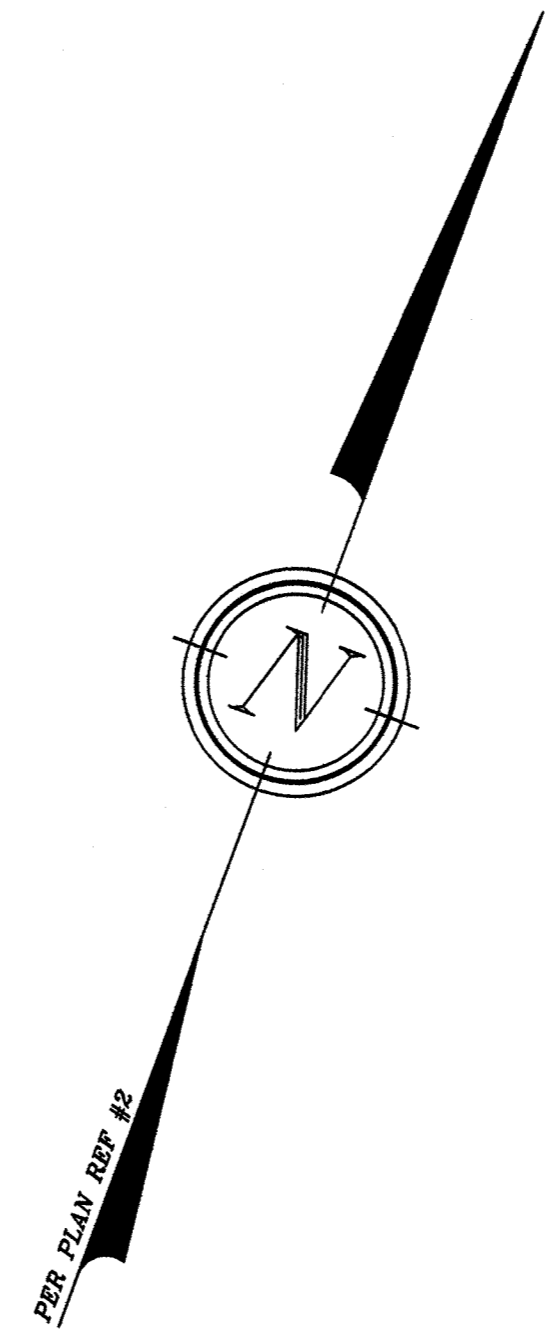

REVISION	DATE	DESCRIPTION

BOUNDARY SURVEY PLAN  
 LAND OF  
 TAMMY L. ROBBINS  
 633 LONG SHORES DRIVE  
 BARRINGTON, N.H.  
 TAX MAP 103, LOT 38

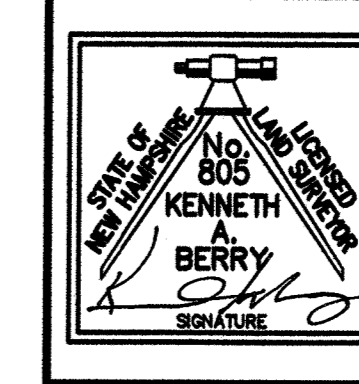

**BERRY SURVEYING & ENGINEERING**  
 335 SECOND CROWN POINT RD.  
 BARRINGTON, N.H. (603)332-2863  
 SCALE : 1 IN. EQUALS 20 FT.  
 DATE : OCTOBER 28, 2020  
 FILE NO. : DB 2020 - 123

I CERTIFY THAT THIS SURVEY PLAT IS NOT A SUBDIVISION PURSUANT TO THIS TITLE AND THAT THE LINES OF STREETS AND WAYS SHOWN ARE THOSE OF PUBLIC OR PRIVATE STREETS OR WAYS ALREADY ESTABLISHED AND THAT NO NEW WAYS ARE SHOWN.  
 KENNETH A. BERRY L.L.S. 805 DATE 10-28-20