

- NOTES:**
1. THE INTENT OF THIS PLAN IS TO SHOW A WETLAND BUFFER IMPACT FOR THE DRIVEWAY TO LOT 1 OF THE RAMSDALL WOODS SUBDIVISION APPROVED ON 2013. A SECTION 9.5 APPLICATION FOR A SPECIAL PERMIT TO CONSTRUCTION IN WETLAND BUFFER IS BEING SUBMITTED AS PART OF THIS APPLICATION. APPLICATION WAS APPROVED ON 7-9-2019 BY A 4-1 VOTE BY THE BARRINGTON PLANNING BOARD.
 2. SUBDIVISION APPR. NO.: SA2014010432 DATED: 6-2-2014
 3. DEED REFERENCE: BK. 4226 PG. 0582 STRAFFORD COUNTY REGISTRY OF DEEDS; OWNER: BARTHOMES, LLC P.O. BOX 334 STRATHAM, NH 03885
 4. WETLANDS SHOWN ON THIS PLAN WERE DELINEATED BY MARK WEST DURING JULY 2013 WHEN THE ORIGINAL SUBDIVISION WAS APPROVED THE BARRINGTON PLANNING BOARD. SEE WETLAND NOTE ON THIS PLAN. WETLANDS WE REVIEWED BY MARK WEST DURING MAY OF 2019 AND CONFIRMED THEY REMAIN AS ORIGINALLY DELINEATED.
 5. ZONING DISTRICT: NEIGHBORHOOD RESIDENTIAL - NR
 CONSERVATION SUBDIVISION REQUIREMENTS:
 FRONT SETBACK - 25'
 SIDE SETBACK - 20'
 REAR SETBACK - 20'
 LOT WIDTH AT FRONT SETBACK - 75'
 WETLAND SETBACK - 50' (HYDRIC "B")
 WETLAND SETBACK - 100' (HYDRIC "A")
 6. THE SUBJECT PARCEL IS LOCATED IN THE FLOOD ZONE "X", (AREAS DETERMINED TO BE OUTSIDE OF THE 500 YEAR FLOOD ZONE), AS SHOWN ON COMMUNITY PANEL NUMBER 33017002850 DATED: MAY 17, 2005.
 7. VERTICAL ELEVATION ARE ON AN ASSUMED DATUM.

PROPOSED WETLAND BUFFER IMPACT _____
 WETLAND IMPACT DURING SUBDIVISION APPROVAL _____

- WETLAND NOTES:**
1. MARK WEST, CERTIFIED WETLAND SCIENTIST OF WEST ENVIRONMENTAL OF LEE, NH PERFORMED THE WETLAND MAPPING DURING JULY 2013 ACCORDING TO THE TECHNICAL CRITERIA OF THE CORPS OF ENGINEERS WETLAND DELINEATION MANUAL, TECHNICAL REPORT Y-87-1, DELINEATION MANUAL: NORTH CENTRAL AND NORTHEAST REGION, VERSION 2.0, JANUARY 2012, US ARMY CORPS OF ENGINEERS.
 2. HYDROCHYTIC VEGETATION WAS IDENTIFIED USING THE NATIONAL LIST OF PLANT SPECIES THAT OCCUR IN WETLANDS: NEW HAMPSHIRE, PUBLISHED BY THE UNITED STATES FISH AND WILDLIFE SERVICE, AMY 1998.

LEGEND

EXISTING STONEWALL	-----
ADJUTERS PROPERTY LINES	-----
SUBJECT PROPERTY LINES	-----
EDGE OF PAVEMENT	-----
WETLANDS BOUNDARY (WETLANDS OVERLAY DISTRICT)	-----
EXISTING TREELINE	-----
EXISTING CONTOUR (MNR)	-572- - - - -
EXISTING CONTOUR (M.R)	-570- - - - -
EXISTING BLDG SETBACK	-----
REBAR W/CAP	●
GRANITE BOUND	■

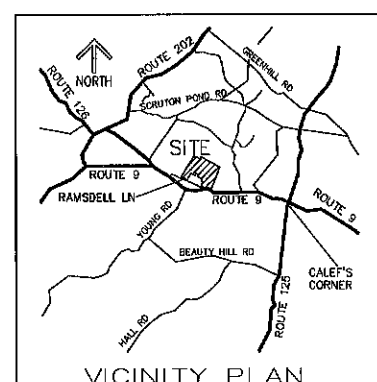

**PLANNING BOARD
 BARRINGTON, NH**
- APPROVED -
 File Number **233-30.1A-NR-19-9.6**
 Date **7/17/2019**
 Chairman *[Signature]*

REVISIONS

REV.	DATE	DESCRIPTION
3	7-11-19	GRADE REVISIONS/FINAL SUBMITTAL
2	6-29-19	DRIVEWAY REVISIONS
1	6-4-19	ADDED PROFILE & MEASUREMENTS TO WETLANDS

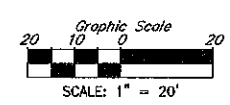

N.H. LAND CONSULTANTS
 SURVEYING • LAND PLANNING • REAL ESTATE
 A VETERAN OWNED COMPANY
 683C FIRST NH TURNPIKE, NORTHWOOD, NH 03261 PH. 603-942-9220 WEBSITE: NH.LANDCONSULTANTS.COM

WETLAND IMPACT PLAN
 TAX MAP 233 LOT 30-1A
BARHOMES, LLC
 THATCHER WAY
 BARRINGTON, NH
 OWNED BY
BARHOMES, LLC
 P.O. BOX, STRATHAM, NH 03885
 BOOK 4226 PAGE 0582

JOB NO: 21 NHLC
WIP1
 1 of 2

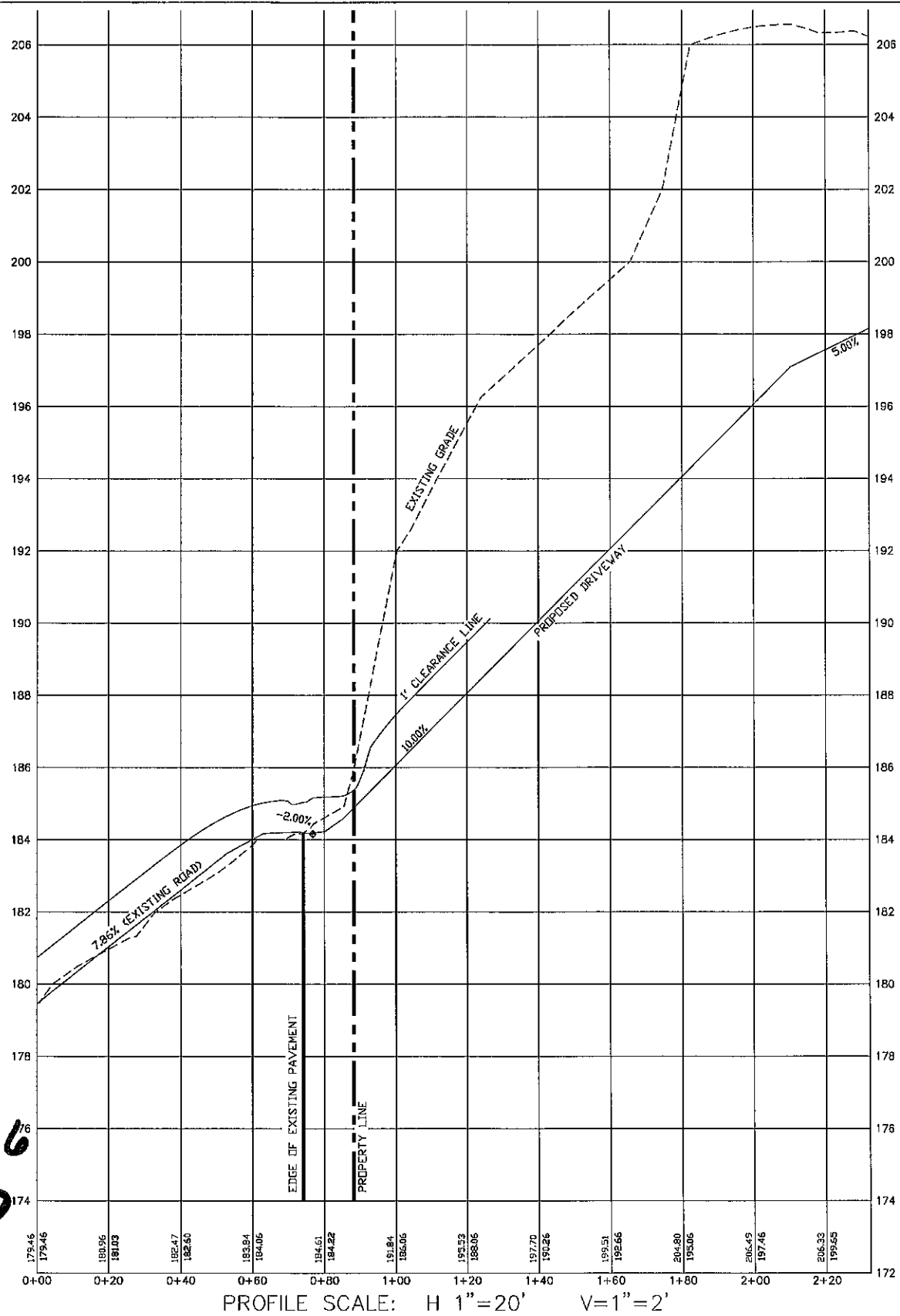

PLANNING BOARD
BARRINGTON, NH
- APPROVED -
 File Number **233-30-1A-NR-19.9.6**
 Date **7/17/2019**
 Chairman *[Signature]*

PROFILE SCALE: H 1" = 20' V 1" = 2'

REVISIONS	
REV.	DESCRIPTION
2	7-11-19 GRADE REVISIONS/FINAL APPROVAL
1	8-4-19 ADDED PROFILE & MEASUREMENTS TO WETLANDS

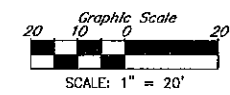

N.H. LAND CONSULTANTS
 SURVEYING • LAND PLANNING • REAL ESTATE
 A VETERAN OWNED COMPANY
 683C FIRST NH TURNPIKE, NORTHWOOD, NH 03251 PH. 603-942-9220 WEBSITE: NH.LANDCONSULTANTS.COM

WETLAND IMPACT PLAN
 TAX MAP 233 LOT 30-1A
BARHOMES, LLC
 THATCHER WAY
 BARRINGTON, NH
 OWNED BY
BARHOMES, LLC
 P.O. BOX, STRATHAM, NH 03885
 BOOK 4226 PAGE 0582

JOB NO: 21 NHLC
P1
 2 of 2