

Project Application

Land Use Department

P.O. Box 660; 333 Calef Hwy, Barrington, NH 03825 ♦ Phone: 603-664-5798 ♦ Fax: 603-664-0188

233-38-NR/HCO-18-SR

Case Number: _____

Project Name: Parking Lot

Date 8/14

Staff Signature required PRIOR to submittal

PRELIMINARY APPLICATION: Preliminary Conceptual Review ___ Design Review ___ Development of Regional Impact ___

FORMAL APPLICATION:

Subdivision Type: Major ___ Minor ___ Conventional ___ Conservation ___

Site Plan Review: Major ___ Minor ___

Conditional Use Permit ___ Sign Permit ___ Boundary Line Adjustment ___ Special Permit ___

Change of Use ___ Extension for Site Plan or Subdivision Completion ___

Amendment to Subdivision/Site Plan Approval ___ Other ___

Project Name: Parking Lot Franklin Pierce Hwy Area (Acres or S.F) _____

Project Address: Franklin Pierce Hwy

Current Zoning District(s): NR/HCO Map(s) 233 Lot(s) 38

Request: Parking Lot

The property owner shall designate an agent for the project. This person (the applicant) shall attend pre-application conferences and public hearings, will receive the agenda, recommendations, and case reports, and will communicate all case information to other parties as required.

All contacts for this project will be made through the Applicant listed below.

Owner: Town of Barrington

Company _____

Phone: 603-5798 Fax: _____ E-mail: _____

Address: POB 660, Barrington NH 03825

Applicant (Contact): _____

Company _____

Phone: _____ Fax: _____ E-mail: _____

Address: SAME

Developer: _____

Company _____

Phone: _____ Fax: _____ E-mail: _____

Address: _____

Architect: _____

Company _____

Phone: _____ Fax: _____ E-mail: _____

Address: _____

Engineer: _____

Company _____

Phone: _____ Fax: _____ E-mail: _____

Address: _____

Owner Signature
[Signature]
Staff Signature

Applicant Signature
[Signature]
Date 8/15/2018

LAND USE OFFICE

AUG 14 2018

RECEIVED

ABUTTER LIST

Town of Barrington, NH
Please Print or Type

Applicant: Town of Barrington Conservation Com. Phone 664-5798

Project Address: Franklin Pierce Highway

List the names and addresses of all parties below. For abutting lot owners, list each owner whose lot adjoins or is directly across the street or a body of water from the subject property. This form may not be completed more than five (5) days prior to the application deadline.

LEGAL OWNER OF SUBJECT LOT

Map	Lot	Zone	Owner Name	Mailing Address
233	38		Town of Barrington	PO 660 Barrington NH

ABUTTING LOT OWNERS

Map	Lot	Owner Name	Owner Mailing Address (NOT property location)
240	1	Theodore + Gail Kittredge	19 Richardson Drive Barrington
233	36	Steven Kittredge	5 Richardson Drive Barrington
233	37	William L + Karla A Cooper	8 Richardson Drive Barrington
233	35	Robert + Rebecca Litchfield	901 Franklin Pierce Hwy Barrington
233	34	Daniel + Cristin Wagner	911 Franklin Pierce Hwy Barrington
233	33	Timothy R. Dwyer	3 Arthur Ave Hooksett, NH 03106
233	32-2	Leuasouvn Vanthy + Ting Kham	925 Franklin Pierce Hwy Barrington
233	32-1	Stephen P. Bunker	927 Franklin Pierce Hwy Barrington
233	31	Richard Melanson	937 Franklin Pierce Hwy Barrington
233	30	Ramsdell Woods Assoc	P.O. Box 334 Stratham NH 03885

PROFESSIONALS AND EASEMENT HOLDERS. Engineers, Surveyors, Soil Scientists, and Architects whose seal appears or will appear on the plans (other than any agent submitting this application); holders of conservation, preservation, or agricultural easements; and upstream dam owners/NHDES.

Name of Professional or Easement Holder	Mailing Address

I, the undersigned, acknowledge that it is the responsibility of the applicant or his/her agent to fill out this form. I understand that any error or omission could affect the validity of any approval. The names and address listed on this form were obtained from the Town of Barrington Assessing Office

on this date: _____, This is page _____ of _____ pages.

LAND USE OFFICE

Applicant or Agent: _____

AUG 14 2018

Planning Staff Verification: _____ Date: _____

RECEIVED

ABUTTER LIST

Town of Barrington, NH

Please Print or Type

Applicant: Town of Barrington Cons Com Phone 664-5798

Project Address: Franklin Pierce Highway

List the names and addresses of all parties below. For abutting lot owners, list each owner whose lot adjoins or is directly across the street or a body of water from the subject property. This form may not be completed more than five (5) days prior to the application deadline.

LEGAL OWNER OF SUBJECT LOT

Map	Lot	Zone	Owner Name	Mailing Address

ABUTTING LOT OWNERS

Map	Lot	Owner Name	Owner Mailing Address (NOT property location)
233	39	Gary + Brenda Ramsdell	27 Ramsdell Lane Barrington
233	40	John B + Janet M. Ramsdell	33 Ramsdell Lane Barrington, NH
233	54	Cynthia King	1014 Franklin Pierce Hwy Barrington
233	53	Cynthia King	1014 Franklin Pierce Hwy Barrington
233	46	Ernest 39 Holdings LLC	13 Copeland Dr. Rochester, NH
233	45	Roland + Cora G. Pecore	PO Box 293 Barrington 03807
240	16	David + Margaret Scott	40 Young Road Barrington NH
240	8	Norma Rearden	802 North Union St. Natchez MS 39120
249	18	Donetta + James Haley	PO Box 367 Barrington
240	7	Donetta + James Haley	PO Box 367 Barrington

PROFESSIONALS AND EASEMENT HOLDERS. Engineers, Surveyors, Soil Scientists, and Architects whose seal appears or will appear on the plans (other than any agent submitting this application); holders of conservation, preservation, or agricultural easements; and upstream dam owners/NHDES.

Name of Professional or Easement Holder	Mailing Address

I, the undersigned, acknowledge that it is the responsibility of the applicant or his/her agent to fill out this form. I understand that any error or omission could affect the validity of any approval. The names and address listed on this form were obtained from the Town of Barrington Assessing Office

on this date: _____, This is page _____ of _____ pages.

Applicant or Agent: _____

Planning Staff Verification: _____ Date: _____

LAND USE OFFICE

AUG 14 2010

RECEIVED

ABUTTER LIST

Town of Barrington, NH
Please Print or Type

Applicant: Town of Barrington Conds. Com Phone 604-5798

Project Address: Franklin Pierce Highway

List the names and addresses of all parties below. For abutting lot owners, list each owner whose lot adjoins or is directly across the street or a body of water from the subject property. This form may not be completed more than five (5) days prior to the application deadline.

LEGAL OWNER OF SUBJECT LOT

Map	Lot	Zone	Owner Name	Mailing Address

ABUTTING LOT OWNERS

Map	Lot	Owner Name	Owner Mailing Address (NOT property location)
240	4	Stephan Rubinstein Tr	71 Hancock St. Lexington, MA 02426
239	64	Scott + Gail Byron	113 Pasture Hill Rd Barrington
239	65	Paul J + Karen Noury	50 Richardson Dr. Barrington
240	3	Anthony A. Sarcione	287 Province Rd Stratford NH 03884-6042
240	2	Amy R + Trent M. Lefebvre	35 Richardson Dr. Barrington

PROFESSIONALS AND EASEMENT HOLDERS. Engineers, Surveyors, Soil Scientists, and Architects whose seal appears or will appear on the plans (other than any agent submitting this application); holders of conservation, preservation, or agricultural easements; and upstream dam owners/NHDES.

Name of Professional or Easement Holder	Mailing Address

I, the undersigned, acknowledge that it is the responsibility of the applicant or his/her agent to fill out this form. I understand that any error or omission could affect the validity of any approval. The names and address listed on this form were obtained from the Town of Barrington Assessing Office

on this date: _____, This is page _____ of _____ pages.

Applicant or Agent: _____

Planning Staff Verification: _____ Date: _____

LAND USE OFFICE

AUG 14 2018

RECEIVED

**NOT FOR
CONSTRUCTION**

NO.	DATE	DESCRIPTION	BY	CK'D

GOODWILL
CONSERVATION
245 FRANKLIN
PIERCE HWY
BARRINGTON, NH
03825

DRAWING DESCRIPTION

**SITE
IMPROVEMENTS
PLAN & PROFILE**

DRAWN BY BJV	DATE JUNE 2018
CHECKED BY RLT	DKR PROJECT # 324362
PROJ. ENG. RLT	DKR ARCHIVE #

DRAWING NO.

C.1

SHEET 1 OF 1

LEGEND

EXISTING CONDITIONS

- MINOR CONTOUR
- MAJOR CONTOUR
- EDGE OF WOODS
- ROADWAY CENTERLINE
- EDGE OF ROAD PAVED
- GRAVEL DRIVE
- HIKING TRAIL
- WET AREA
- OVER HEAD POWER LINES
- WALL STONE
- EDGE OF POND
- IRON PIPE
- HVCTRL
- BENCHMARK
- COMB
- DECIDUOUS TREE

PROPOSED CONDITIONS

- LIMIT OF WORK
- EDGE OF WOODS
- MAJOR CONTOUR
- MINOR CONTOUR
- ROADWAY ALIGNMENT
- EDGE OF GRAVEL
- REPRESENTATIVE PARKING SPACES
- AREA TO BE RE-GRADED WITH NEW GRAVEL
- PARKING LOT ENTRANCE

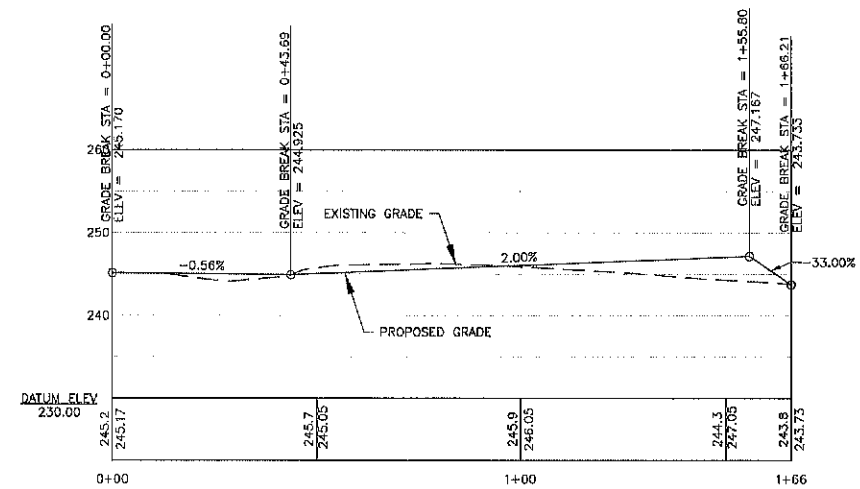
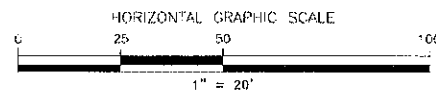

LAND USE OFFICE

AUG 14 2018

RECEIVED