

MAGNETIC PERM PLAN REFERENCE

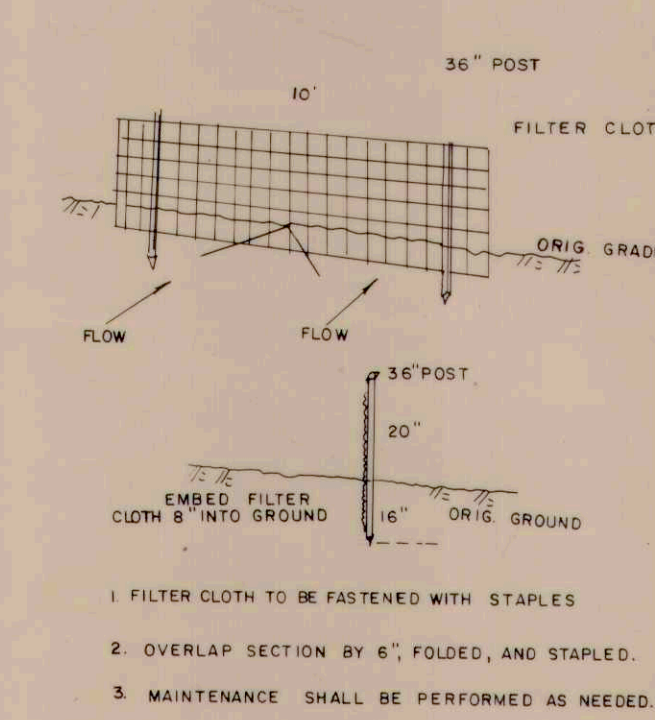

MAP 13 / LOT 21A & 21E
 N/F DAVID R. NOYES
 25 MILL ROAD
 DURHAM, NH 03824
 DEED REF. 779 - 443

MAP 13 / LOT 21B
 N/F TOMMY BLAKE REALTY
 92 BLAKE ROAD
 DURHAM, NH 03824
 DEED REF. 158 - 881
 ALSO SEE DEEDER CALDWELL PRIBBE

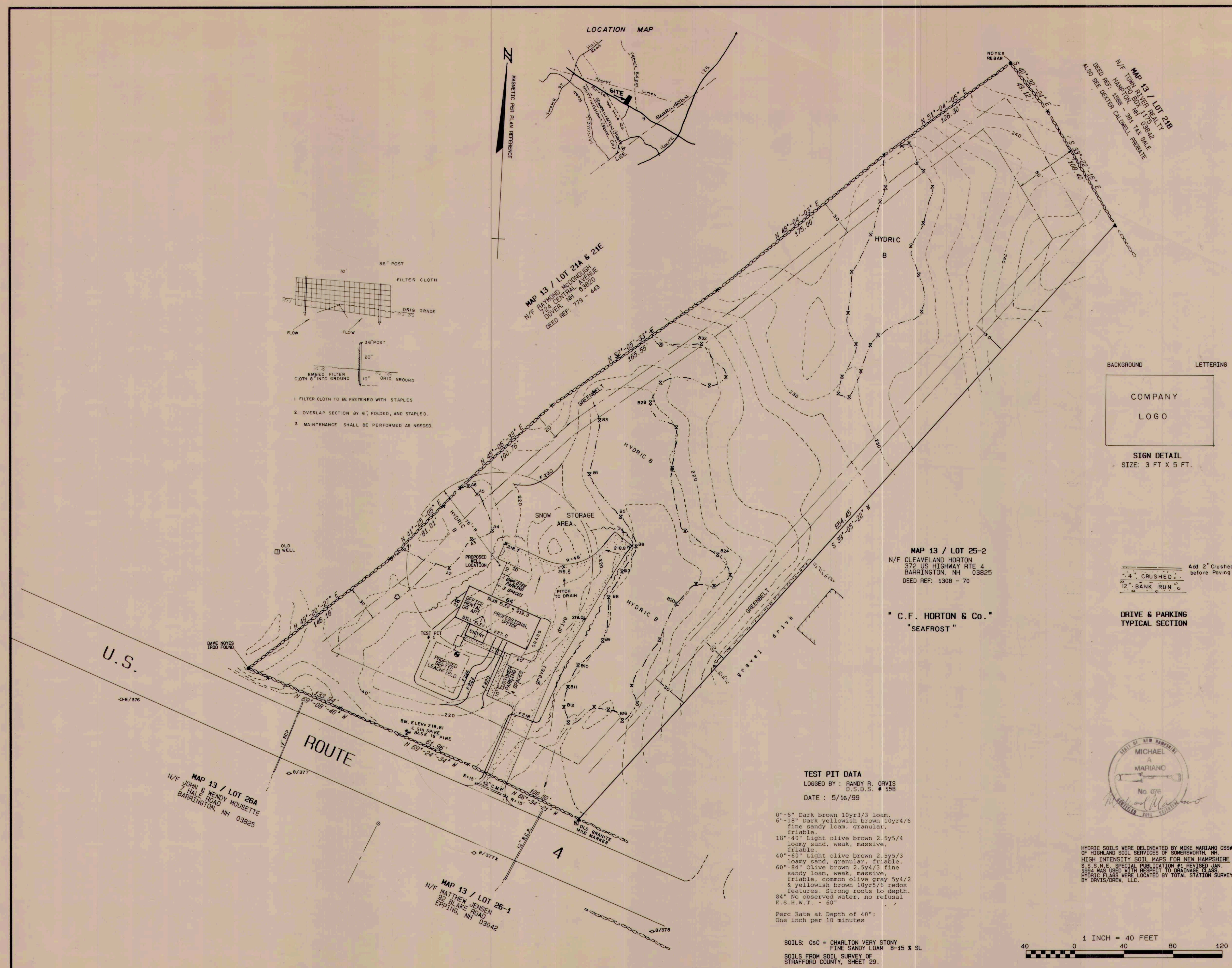

BACKGROUND LETTERING
 COMPANY LOGO

SIGN DETAIL
 SIZE: 3 FT X 5 FT.

1/4" CRUSHED BANK RUN
 Add 2" Crushed before Paving

DRIVE & PARKING TYPICAL SECTION

MAP 13 / LOT 25-2
 N/F CLEAVELAND HORTON
 372 US HIGHWAY RTE 4
 BARRINGTON, NH 03825
 DEED REF. 1308 - 70

"C.F. HORTON & Co."
 "SEAFROST"

TEST PIT DATA
 LOGGED BY: RANDY R. ORVIS
 D.S.D.S. # 158
 DATE: 5/16/99

0"-6" Dark brown 10yr3/3 loam.
 6"-18" Dark yellowish brown 10yr4/6 fine sandy loam, granular, friable.
 18"-40" Light olive brown 2.5y5/4 loamy sand, weak, massive, friable.
 40"-60" Light olive brown 2.5y5/3 loamy sand, granular, friable.
 60"-84" Olive brown 2.5y4/3 fine sandy loam, weak, massive, friable, common olive gray 5y4/2 & yellowish brown 10yr5/6 redox features. Strong roots to depth.
 84" No observed water, no refusal
 E.S.H.W.T. - 60"
 Perc Rate at depth of 40":
 One inch per 10 minutes

SOILS: C6C = CHARLTON VERY STONY FINE SANDY LOAM 8-15% SL
 SOILS FROM SOIL SURVEY OF STRAFFORD COUNTY, SHEET 29.

HYDRIC SOILS WERE DELINEATED BY MIKE MARIANO CSS# OF HIGHLAND SOIL SERVICES OF SOMERWORTH, NH. HIGH INTENSITY SOIL MAPS FOR NEW HAMPSHIRE S.S.S.N.E. SPECIAL PUBLICATION #1 REVISED JAN. 1994 WAS USED WITH RESPECT TO DRAINAGE CLASS. HYDRIC CLASS WERE LOCATED BY TOTAL STATION SURVEY BY ORVIS/DREW, LLC.

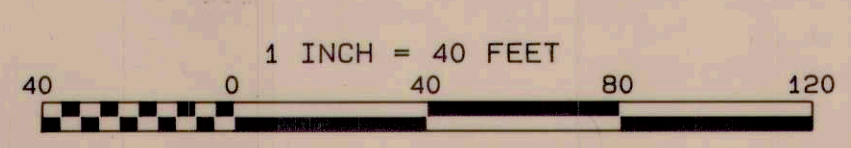

GENERAL NOTES

- ZONING: HIGHWAY DISTRICT
 - TAX MAP # 13 / LOT # 25-1
 - TITLE SOURCE: S. C. R. D. BOOK 1005, PAGE 829
 - OWNER OF RECORD: ANNE B. HEISEY
25 MILL ROAD
DURHAM, NH 03824
- SIGNATURE OF OWNER:
- TOTAL LOT AREA: 3.641 AC. - 158,584 S.F.
 - THE PERIMETER OF THIS PLAN WAS PREPARED FROM A RANDOM TRAVERSE USING A TOPCON GTS 2B TOTAL STATION AND HUSKY FS-2 DATA COLLECTOR. UNADJUSTED ERROR OF CLOSURE WAS 1 PART IN 22,200.
 - NO VISIBLE BURIAL GROUNDS WERE FOUND.
 - THERE ARE NO PRIME WETLANDS LOCATED ON THE SUBJECT LOT PER BARRINGTON PRIME WETLANDS MAPS - SHEET 7

REFERENCE PLANS

- "2 LOTS FOR DANIEL J. HEISEY" BY DAVID R. NOYES DATED 5/20/77, SCALE: 1"=50', RECORDED IN STRAFFORD COUNTY REGISTRY OF DEEDS AS PLAN # 17A - 181.

SITE PLAN NOTES

- BUILDING COLOR: LIGHT TAN OR BEIGE VINYL SIDING
 - ROOF: DARK BROWN ASPHALT SHINGLES
 - SIGN PLACEMENT: AT HIGHWAY
NUMBER and SIZE: 1, 3' x 5', EXTERNALLY LIT
 - DRIVE & PARKING: GRAVEL NOW, FUTURE HOT TOP
 - HOURS OF OPERATION: 7:00 AM to 5 PM
 - PARKING: 28' x 64' = 1,792 s.f ± 250 = 7 SPACES
 - LIGHTING: MOTION FLOOD IN REAR
2-35 WATT WALLLIGHTER ON FRONT
INCADESCENT LAMP POST AT PARKING
 - TRASH REMOVAL: WEEKLY BY PRIVATE CONTRACT
- N.H.D.E.S. SEPTIC DESIGN
 APPROVAL NO. CA1999019781

LEGEND

- PROPOSED DRIVE
- IRON ROD FOUND / CAPPED
- IRON ROD SET
- SET BACK LINE
- BUILDING
- HYDRIC B SOIL LINE
- UTILITY POLE
- EXISTING CONTOURS
- PROPOSED CONTOURS
- N/F = NOW OR FORMERLY
- S.C.R.D. = STRAFFORD COUNTY REGISTRY OF DEEDS
- SILT FENCE

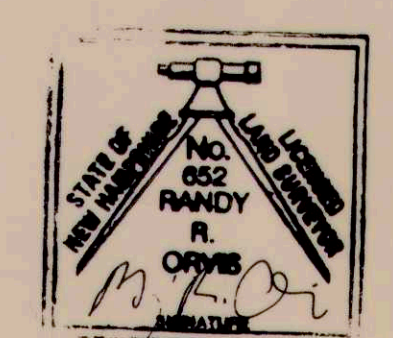

PLANNING BOARD
 APPROVAL BLOCK
 PLANNING BOARD
 BARRINGTON, N.H.
 -APPROVED-
 File Number: 99-050
 Date: 12/28/99
 Chairman: Dawn Husted, Esq.

THIS SURVEY WAS PERFORMED BY ME OR THOSE UNDER MY DIRECT SUPERVISION RANDY R. ORVIS - L.L.S. #552 P.O. BOX 277 FARMINGTON, NH 03835

THE SITE PLAN REGULATIONS ARE A PART OF THIS PLAN AND APPROVAL OF THIS PLAN IS CONTINGENT ON COMPLETION AT ALL THE REQUIREMENTS SET FORTH IN THE APPLICABLE REGULATIONS EXCEPTING ANY MODIFICATIONS MADE IN WRITING BY THE BOARD AND ATTACHED HERETO.

SIGNATURE OF OWNER
 Robert E. Mutch

SITE PLAN FOR
 ROBERT E. MUTCH
 ON LAND OF
 ANNE B. HEISEY
 BARRINGTON, NEW HAMPSHIRE
 STRAFFORD COUNTY

DATE: APRIL 1999 FILE No. 99-050 PLAN # OD 792
 REVISIONS: D.E.S SEPTIC DESIGN APPR. NO. C.S.S. STAMP

ORVIS/DREW LLC
 88 ROUTE 9
 PO BOX 239
 BARRINGTON, NH 03825
 603-664-2821
 603-859-2367
 603-859-2360

270-69

Robert Mutch
 Anne Heisey
 Offices Ref 4
 Map 13 Lot 25-1
 SR 99/183
 NC
 12/28/1999