

## BUILDING CODE AND LIFE SAFETY INFORMATION

### Code References:

- 2015 INTERNATIONAL BUILDING CODE
- 2015 INTERNATIONAL BUILDING ENERGY CODE
- 2015 NFPA 101 LIFE SAFETY CODE
- NH RSA 155-A: 5 / 2009 ANSI A117.1 / 2010 ADAAG

Per New Hampshire law NFPA 101 and IBC are compared for Means of Egress and the most restrictive determines compliance requirements

### Project Description

This project consists of the construction of a new one story, 9,471sf of Type VB construction Town Hall. The building will be used for Town offices and meeting space as Business and Assembly A-3 occupancy types.

Exterior wall construction to be ICF. Roof system to be engineered truss ventilated attic. The building is non-sprinkled.

### Building Data :

Occupancies: Business Group B, Assembly Group A-3, (Mixed, multiple occupancy, non-separated)

Building height in feet: Approximately 18'-0" average grade to mid slope of highest roof  
 Number stories above grade : One  
 Footprint area: 9,417 sf  
 Construction type: Type V-B  
 Area increase due to frontage: 4,500 sf (building qualifies based on 100% of perimeter on public way or open space)  
 Sprinkler system: None

### Height and Area Limitations:

Height limitation:  
 Building height above grade plane limitation: 1 story, 40' IBC tables 504.3 / 504.4  
 Increase for sprinkler: N/A IBC section 504.2  
 Adjusted height limitation: N/A

Area limitation:  
 Allowable Area Factor: 6,000 SF based on most restrictive A-3 occupancy IBC table 506.2  
 Street frontage increase: 4,500 SF based on 100% open space perimeter IBC Section 506.2.2  
 Sprinkler increase: N/A  
 Adjusted area limitation: 10,500 SF based on most restrictive A-3 occupancy

### Mixed Use and Occupancy

General Occupancy Classification: Mixed occupancies, non-separated (B and A-3) IBC Sections 302 & 508  
 Accessory Occupancies: Storage S-1 (accessory to B)  
 Separation of Occupancies: No separation required in non-separated occupancy IBC Section 508.3

### Means of Egress

Occupant load - Ground Level:  
 Business areas: 7,276 SF / 1 person per 100 SF gross = 73 persons IBC table 1004.1.2  
 Accessory Storage Area: 724 SF / 1 person per 300 SF gross = 3 persons IBC table 1004.1.2  
 Assembly A-3 areas: 1,016 SF / 1 person per 15 SF net = 68 persons

Total occupant load: 144 persons

Egress Capacity:  
 Min. capacity at stairs for occupant load served: N/A NFPA 101 table 7.3.3.1  
 Min. required at stairs: N/A NFPA 101 section 7.2.2.2.1.2  
 Min. capacity at exits and corridors: 29 persons x 0.2" per person = 5.8" NFPA 101 table 7.3.3.1  
 Min. required width at exits and corridors: 44" min. at corridors, 32" min. clear width at doors NFPA 101 section 7.3.4

Minimum number of required exits: (2) NFPA 101 section 7.4.1  
 Minimum exit access remoteness: 1/2 diagonal without sprinkler system NFPA 101 section 7.5.1.3.3  
 Maximum common path of travel limit: Assembly: 20' / 75' NFPA 101 Table A7.6  
 Maximum dead end limit: Assembly: 20' NFPA 101 Table A7.6  
 Maximum exit access travel distance: Assembly: 200' NFPA 101 Table A7.6

### Accessibility:

1. Sixty percent of public building entrances must be accessible per IBC section 1105.1.
2. All interior spaces must be accessible
3. Accessible route must be provided from accessible parking space to accessible entrance.

### Fire Ratings (also see fire ratings plan)

Basic building elements based on V-B construction type:  
 Note: may be superseded by interior fire separations

Fire rating:	Code reference:
Structural Frame: 0 hours	2015 IBC table 601
Exterior bearing walls: 0 hours	2015 IBC table 601
Interior bearing walls (not acting as fire separations): 0 hours	2015 IBC table 601
Interior non-bearing walls (not acting as fire separations): 0 hours	2015 IBC table 601
Floor construction: 0 hours	2015 IBC table 601
Roof construction: 0 hours	2015 IBC table 601
Interior fire separations: Corridor Walls: 1 hr. Fire Partitions	2015 IBC section 508

Opening protectives:  
 Corridor Openings: 20 min. 2015 IBC Table 716.5  
 Glazing in Corridors: 20 min. 2015 IBC Table 716.5

### LIFE SAFETY LEGEND

- 1-HOUR FIRE PARTITION
- COMMON PATH TRAVEL DISTANCE
- EXIT LOAD AND DIRECTION OF EGRESS

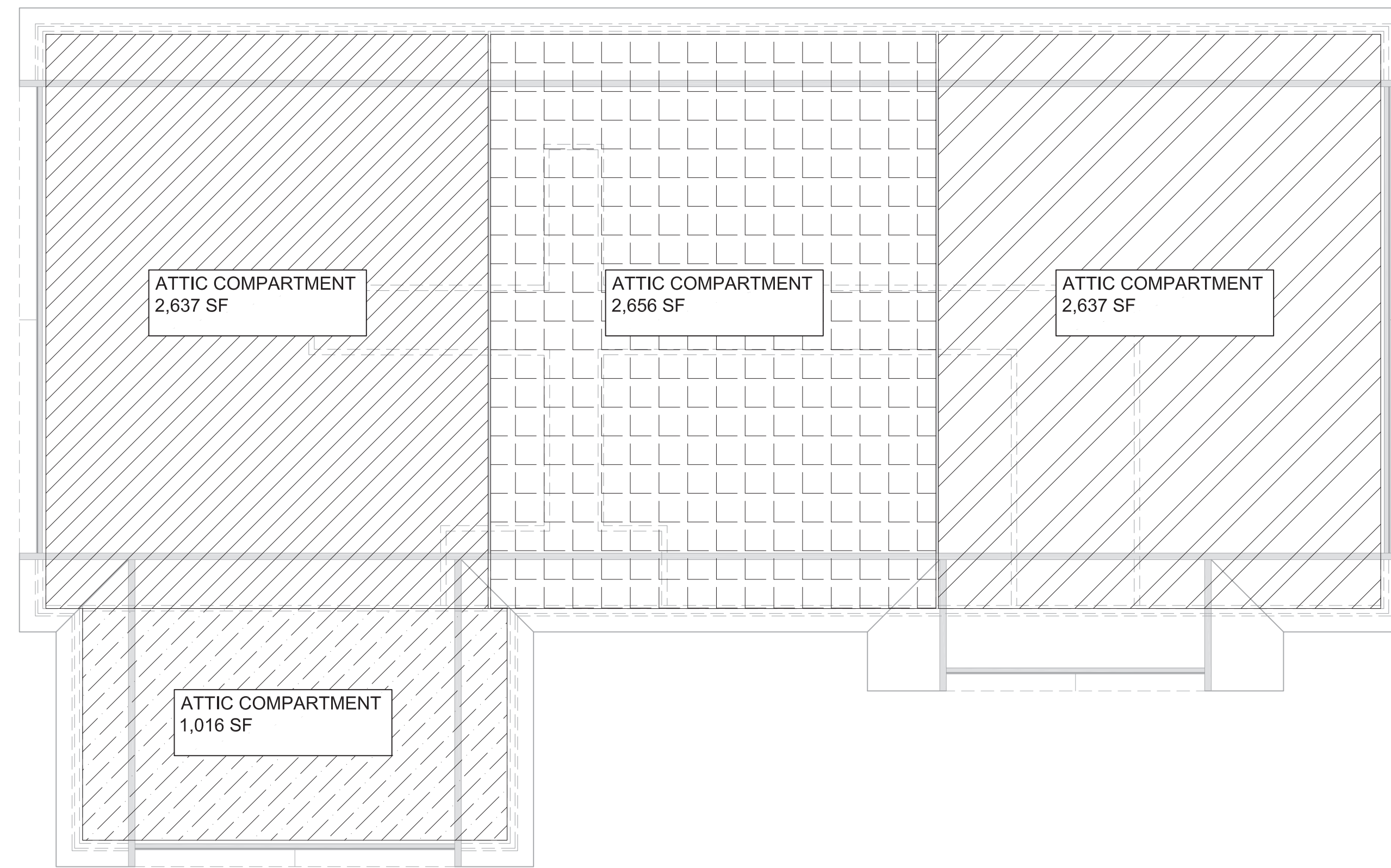

2 ATTIC DRAFTSTOPPING PLAN  
 SCALE: 3/32" = 1'-0"

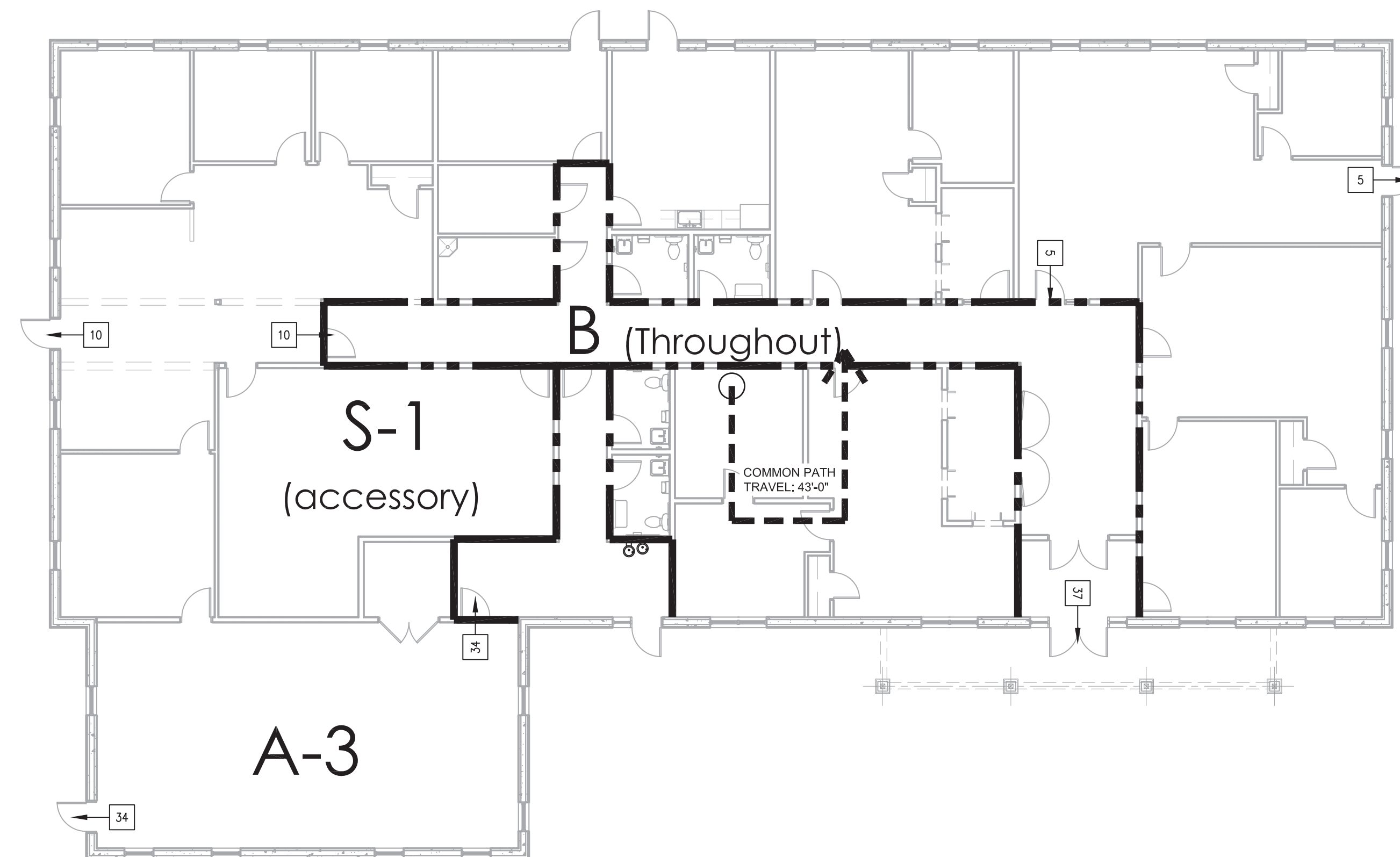

1 FIRST FLOOR PLAN  
 SCALE: 3/32" = 1'-0"

OWNER:  
  
 TOWN OF BARRINGTON  
 PO BOX 660 333 CALIF HIGHWAY  
 BARRINGTON, NH

DESIGN BUILDER:  
  
 Carreno Construction Company, LLC  
 Design Build / Construction Managers / General Contractors  
 270 West Road - Suite 4A  
 Portsmouth, NH 03801  
 p. 603.436.1096 f. 603.436.6620  
 e. build@carrenoconstruction.com

ARCHITECT:  
  
 PORTONE ARCHITECTS  
 959 Islington Street  
 Portsmouth, NH 03801  
 603.436.8891  
 info@portonearchitects.com

CIVIL / STRUCTURAL ENGINEER:  
  
 CIVIL CONSULTANTS  
 Engineers - Planners - Surveyors  
 293 Main Street  
 South Berwick, ME

REVISION HISTORY:

#	DATE	ISSUANCE



### PERMIT DOCUMENTS

USE DISCLAIMER:  
 COPYRIGHT © BY PORTONE ARCHITECTS, INC. 2021  
 NO RE-USE WITHOUT PERMISSION.

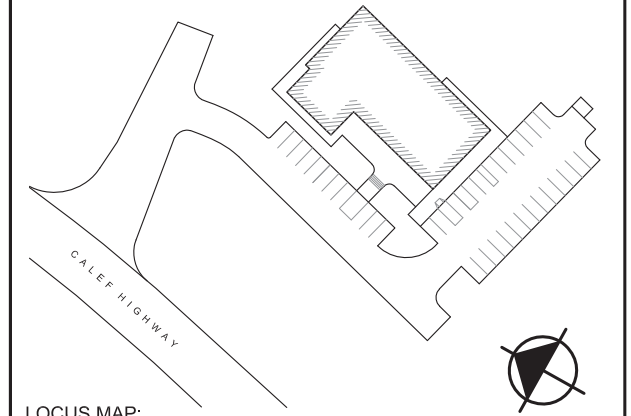

PROJECT NAME:  
**Barrington  
 Town Hall**

DRAWING TITLE:  
**CODE & LIFE  
 SAFETY  
 INFORMATION**

PROJECT No.: 19-062

DATE: DECEMBER 1, 2021

DRAWING SCALE: AS NOTED

SHEET NUMBER:

**LS1.1**