

Town of Barrington
Antenna Tower and Repeater Relocation
Request for Proposals

The Town of Barrington is soliciting proposals to install a new emergency services tower, antenna and relocate our existing 100w VHF repeater from the old town hall building located at 137 Ramsdell Lane to the new site located behind the Public Library located at 105 Ramsdell Lane. Proposals are due March 30, 2015

- The expectation is that work shall be completed before July 1st 2015. If this is unrealistic the proposals shall state what date or range of dates they would realistically target.
- This work shall meet or exceed all FCC, local, state and federal requirements. The town shall acquire the local building permit; contractor shall acquire any others that may be required.
- Successful contractor shall provide the Town of Barrington with proof of a \$1,000,000 (one million dollar) property & liability insurance policy, vehicle insurance and name the Town of Barrington as an additional insured/covered party until the job is completed. Contractor shall also provide proof of valid workman's compensation insurance.
- Contractor shall facilitate the repeater move to coincide with Fairpoint Communications. To ensure that the interruption of repeater operations shall be minimal. Contractor shall provide the Town of Barrington with an estimated repeater down time.
- The Town of Barrington shall provide any required electrical upgrades upon written direction from the contractor.
- The town of Barrington shall provide all site work and concrete work for the tower. Contractor shall provide detailed construction plans for such.
- Tower shall be a 120 foot, self-supporting Trylon S-600 Super Titan, or equivalent, which includes antenna mounts and anti-climbing protection.
- One (1) 6dB VHF Antenna System that includes 7/8" transmission line, proper cable management, R56 grounding, and 12" wide ice bridge a minimum of 10 feet long.

LAND USE OFFICE

MAY 10 2015

RECEIVED

- Provide industry approved proper building penetration using "entry boot".
- Remove and relocate our existing Motorola MTR 2000 Repeater with duplexer and its backup power source to the new location.
- Provide adequate onsite technical staff to handle any issues that may arise during the move and installation.
- Provide any and all license and or modifications required by the FCC.
- Provide the Town of Barrington with a written timeline on completion of all phases of this project.
- A mandatory site walk is required in order to bid this project. The town of Barrington will not accept any bids that have not had a site walk.
- Bid/Quote must be good for 90 days and noted as such on the quote.
- Site visits can be arranged by contacting Fire Chief Rick Walker at 603-664-2241.

Completed quote packages must be in a sealed envelope, marked Tower Quote. Attn: Fire Chief Rick Walker and may be dropped off at the
Barrington Town Office
333 Calef Highway
Barrington NH 03825

Or marked Tower Quote Attn: Fire Chief Rick Walker and mailed to:
Barrington Town Offices
Fire Chief Rick Walker
PO Box 660
Barrington NH 03825

Quote must be delivered or postmarked no later than March 30, 2015 to be considered.

The Town of Barrington Board of Selectmen reserves the right to accept any quote that they feel is in their best interest regardless of lowest proposal. The Board of Selectmen also reserves the right to reject any and all proposals.

LAND USE OFFICE

MAY 12 2015

RECEIVED

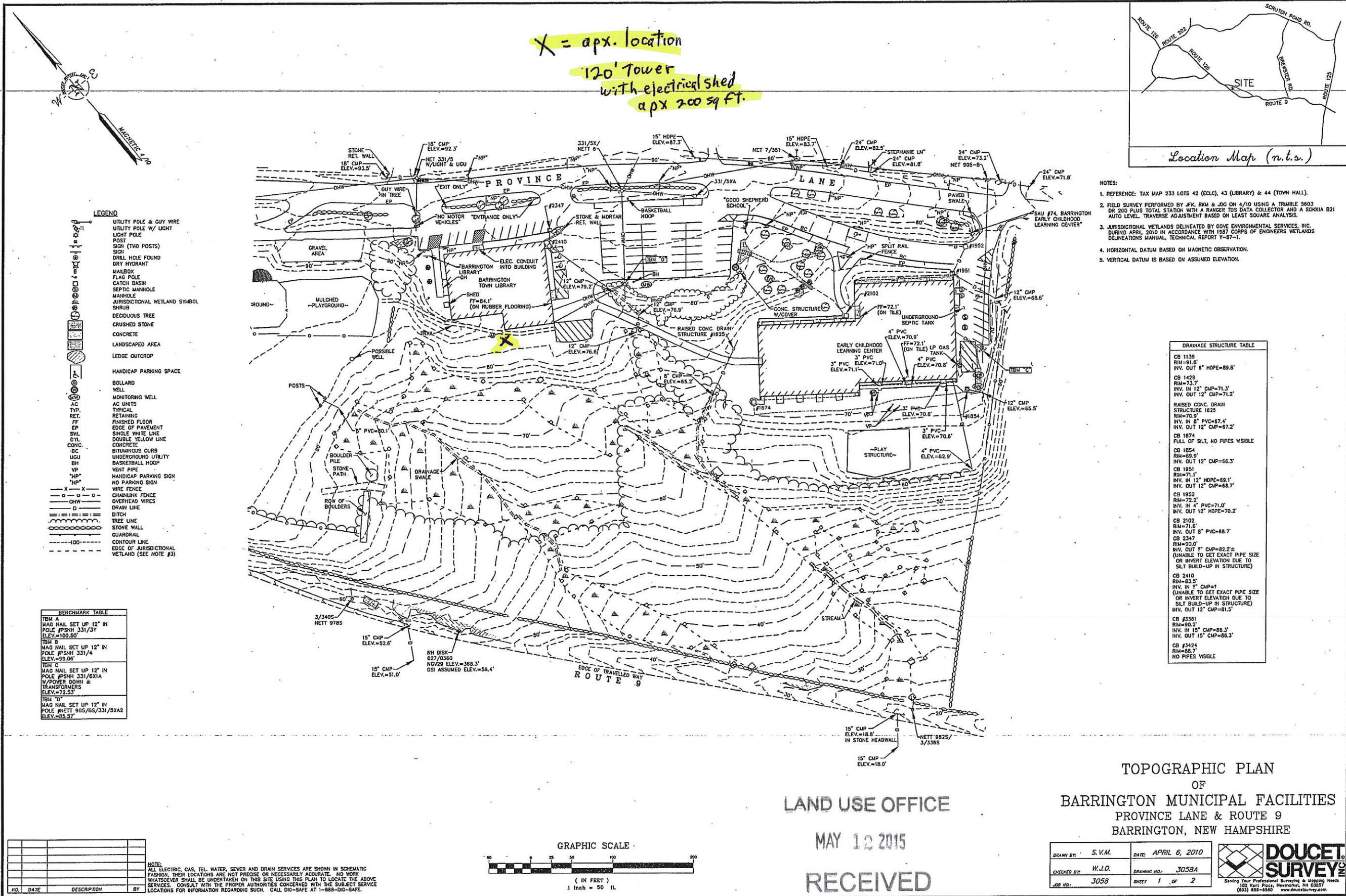

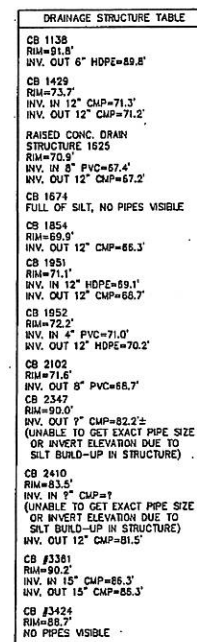

- ### LEGEND
- | | |
|--|--|
| | UTILITY POLE & GUY WIRE |
| | UTILITY POLE W/ LIGHT |
| | LIGHT POLE |
| | POST |
| | SIGN (TWO POSTS) |
| | SIGN |
| | DRILL HOLE FOUND |
| | DRY HYDRANT |
| | MAILBOX |
| | FLAG POLE |
| | CATCH BASIN |
| | SEPTIC MANHOLE |
| | MANHOLE |
| | JURISDICTIONAL WETLAND SYMBOL |
| | SHRUB |
| | DECIDUOUS TREE |
| | CRUSHED STONE |
| | CONCRETE |
| | LANDSCAPED AREA |
| | LEDGER OUTCROP |
| | HANDICAP PARKING SPACE |
| | BOLLARD |
| | WELL |
| | MONITORING WELL |
| | AC UNITS |
| | TYPICAL |
| | RETAINING |
| | FINISHED FLOOR |
| | EDGE OF PAVEMENT |
| | SINGLE YELLOW LINE |
| | DOUBLE YELLOW LINE |
| | CONCRETE |
| | BITUMINOUS CURB |
| | UNDERGROUND UTILITY |
| | BASKETBALL HOOP |
| | VENT PIPE |
| | HANDICAP PARKING SIGN |
| | NO PARKING SIGN |
| | WIRE FENCE |
| | CHAINLINK FENCE |
| | OVERHEAD WIRES |
| | DRAIN LINE |
| | DITCH |
| | TREE LINE |
| | STONE WALL |
| | GUARDRAIL |
| | CONTOUR LINE |
| | EDGE OF JURISDICTIONAL WETLAND (SEE NOTE #3) |

NOTE:
ALL ELECTRIC, GAS, TEL WATER, SEWER AND DRAIN SERVICES ARE SHOWN IN SCHEMATIC FASHION. THEIR LOCATIONS ARE NOT PRECISE OR NECESSARILY ACCURATE. NO WORK WHATSOEVER SHALL BE UNDERTAKEN ON THIS SITE USING THIS PLAN TO LOCATE THE ABOVE SERVICES. CONSULT WITH THE PROPER AUTHORITIES CONCERNED WITH THE SUBJECT SERVICE LOCATIONS FOR INFORMATION REGARDING SUCH. CALL DIG-SAFE AT 1-888-DIG-SAFE.

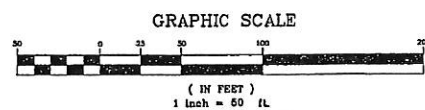

TOPOGRAPHIC PLAN
OF
BARRINGTON MUNICIPAL FACILITIES
PROVINCE LANE & ROUTE 9
BARRINGTON, NEW HAMPSHIRE

DRAWN BY: S.V.M.	DATE: APRIL 6, 2010
CHECKED BY: W.J.D.	DRAWING NO.: 3058A
JOB NO.: 3058	SHEET 2 of 2



RECEIVED

MAY 12 2015

LAND USE OFFICE