

J:\10144-BARRINGTON-356-CALEF-HIGHWAY-TROPIC-STAR.dwg 1/3/2012 8:33:43 AM EST

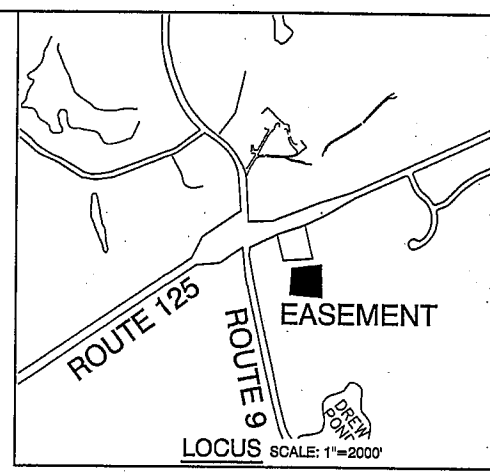

- SITE NOTES:**
1. THE INTENT OF THIS PLAN IS TO DEPICT THE PROPOSED WELL EASEMENT ACROSS TAX MAP 238 LOT 14 IN FAVOR OF TAX MAP 238 LOT 4.
  2. CURRENT OWNER OF RECORD: TAX MAP 238 / LOT 4  
THE THREE SOCIOS, LLC  
32100 LAFAYETTE ROAD  
HAMPTON, NH 03842
  3. CURRENT OWNER OF RECORD: TAX MAP 238 / LOT 14  
BARRINGTON VILLAGE PLACE, LLC  
78 EMERY LANE  
STRATHAM, NH 3885
  3. TOTAL EASEMENT AREA: 8.304 ACRES

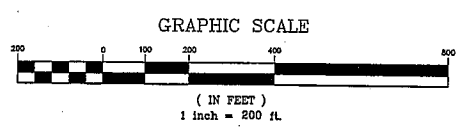

Design: BWG Draft: BWG Date: 08/27/13  
Checked: WGM Scale: AS NOTED Project No.: 10144  
Drawing Name: 10144-PLAN.dwg  
THIS PLAN SHALL NOT BE MODIFIED WITHOUT WRITTEN PERMISSION FROM JONES & BEACH ENGINEERS, INC. (JBE). ANY ALTERATIONS, AUTHORIZED OR OTHERWISE, SHALL BE AT THE USER'S SOLE RISK AND WITHOUT LIABILITY TO JBE.

REV.	DATE	REVISION	BY
1	08/27/13	SUBMITTED FOR REVIEW	BWG

**J/B Jones & Beach Engineers, Inc.**  
Civil Engineering Services  
85 Portsmouth Ave.  
PO Box 219  
Stratham, NH 03885  
603-772-4746  
FAX: 603-772-0227  
E-Mail: JBE@JONESANDBEACH.COM

Plan Name:	PRELIMINARY COMMUNITY WELL PLAN
Project:	VILLAGE PLACE ROUTE 9, BARRINGTON, NH
Owner of Record:	HARBOR STREET LIMITED PARTNERSHIP 78 EMERY LANE, STRATHAM, NH 03885

DRAWING No.  
**P-1**  
SHEET 1 OF 1  
JBE PROJECT NO. 10144