

Project Application

Land Use Department

P.O. Box 660, 333 Calef Hwy, Barrington, NH 03825 • Phone: 603-664-5798 • Fax: 603-664-0188

2023-Canaan Back Rd

Case Number: _____ Project Name: Eversource Energy Date 4-4-23

Staff Signature required PRIOR to submittal

PRELIMINARY APPLICATION: Preliminary Conceptual Review _____ Design Review _____ Development of Regional Impact _____

FORMAL APPLICATION

Subdivision Type: Major _____ Minor _____ Conventional _____ Conservation _____
Site Plan Review: Major _____ Minor _____
Conditional Use Permit _____ Sign Permit _____ Boundary Line Adjustment _____ Special Permit _____
Change of Use _____ Extension for Site Plan or Subdivision Completion _____
Amendment to Subdivision/Site Plan Approval _____ Other _____

Project Name: Eversource Energy maintenance trimming Area (Acres or S.F.) _____

Project Address: Back Canaan Rd

Current Zoning District(s): _____ Map(s) _____ Lot(s) _____

Request: _____

The property owner shall designate an agent for the project. This person (the applicant) shall attend pre-application conferences and public hearings, will receive the agenda, recommendations, and case reports, and will communicate all case information to other parties as required.

All contacts for this project will be made through the Applicant listed below.

Owner: _____
Company: _____
Phone: _____ Fax: _____ E-mail: _____
Address: _____

Applicant (Contact): Eversource Energy - Crystal Franciosi representing
Company: ACRT / Eversource Energy
Phone: 603-831-9806 Fax: _____ E-mail: _____
Address: _____
c.franciosi@acrtinc.com
crystal.franciosi@eversource.com

Developer: _____
Company: _____
Phone: _____ Fax: _____ E-mail: _____
Address: _____

Architect: _____
Company: _____
Phone: _____ Fax: _____ E-mail: _____
Address: _____

Engineer: _____
Company: _____
Phone: _____ Fax: _____ E-mail: _____
Address: _____

Owner Signature
[Signature]
Staff Signature 4/10/23

Crystal Franciosi
Applicant Signature

Date 4-4-23

RECEIVED

APR 10 2023



Attention: Town of Barrington NH

RE: Planned Vegetation Maintenance

Eversource Energy has planned vegetation maintenance scheduled in 2023 within the town of Barrington NH. This work is part of our mandated cyclical maintenance trimming that is performed within the communities that we serve every 4-5 years. This work is critical when it comes to maintaining electrical reliability and safety to our customers.

The work is contracted with Northern Tree Service and will be directly overseen by Crystal Franciosi who is a contracted arborist that oversees our program work in the Epping Area Work Center.

Please reach out to Crystal or me directly if you have any questions or concerns now, during or after the work has been performed.

Thank you.

Ian Farley

Eversource Energy NH

Supervisor: Vegetation Management

Phone: 603-634-2586

A handwritten signature in black ink, appearing to read "Ian Farley", written over the printed name and title.

RECEIVED

APR 10 2023

LAND USE OFFICE

"Safety First and Always"



PO Box 330
Manchester, NH 03105

Tuesday March 28th 2023

Town of Barrington Planning Board

4 Signature Dr.

Barrington, NH 03825

Dear Planning Board Members:

This letter is to inform the town of Barrington that Eversource is requesting the approval to complete scheduled maintenance trimming on two scenic roads in Barrington. This work is necessary to ensure the safe distribution of power and improve reliability of electric service for our customers.

According to Eversource records, Canaan Back Rd and Old Settlers Rd (Old Canaan Rd) are scenic roads in the Town of Barrington. Please consider this letter to be a request from Eversource for a public hearing for the purpose of trimming, pursuant to RSA 231:158. This information will be presented to the board. Please inform this office of the date, time, and place of said meeting so that we may have a representative present.

All work will be performed in accordance with accepted arboriculture standards.

Eversource requires that our contractors contact each landowner where trees are to be trimmed prior to commencement of work on that property. Individual concerns will be addressed at this time.

If you have any questions or concerns, please feel free to contact me either by work cell: 603-831-9806, or by email at cfranciosi@acrtinc.com, or crystal.franciosi@eversource.com

Thank you for your assistance.

Respectfully,

Crystal Franciosi

Consulting Utility Forester with ACRT

Certified Utility Arborist contracted with Eversource Energy

603-831-9806

RECEIVED

APR 10 2023

LAND USE OFFICE



PO Box 330
Manchester, NH 03105

Tuesday March 28th 2023

Town of Barrington Planning Board

4 Signature Dr.

Barrington, NH 03825

Dear Planning Board Members:

This letter is to inform the town of Barrington that Eversource is requesting the approval to complete scheduled maintenance trimming on a scenic road in Barrington. This work is necessary to ensure the safe distribution of power and improve reliability of electric service for our customers.

According to Eversource records, **Back Canaan Rd is a scenic road in the Town of Barrington**. Please consider this letter to be a request from Eversource for a public hearing for the purpose of trimming, pursuant to RSA 231:158. This information will be presented to the board. Please inform this office of the date, time, and place of said meeting so that we may have a representative present.

All work will be performed in accordance with accepted arboriculture standards.

Eversource requires that our contractors contact each landowner where trees are to be trimmed prior to commencement of work on that property. Individual concerns will be addressed at this time.

If you have any questions or concerns, please feel free to contact me either by work cell: 603-831-9806, or by email at cfranciosi@acrtinc.com, or crystal.franciosi@eversource.com

Thank you for your assistance.

Respectfully,

Crystal Franciosi

Consulting Utility Forester with ACRT

Certified Utility Arborist contracted with Eversource Energy

603-831-9806

RECEIVED

APR 10 2023

LAND USE OFFICE

TOWN OF BARRINGTON - LAND USE DEPARTMENT

PROJECT NARRATIVE

PROJECT NAME Eversource Energy CASE FILE NUMBER _____

PROJECT LOCATION Back Canaan Rd (Canaan Back Rd)

DATE OF APPLICATION 3-28-23

Property Details:

Single-Family _____ Residential _____ Multi-Family Residential _____ Commercial _____ Industrial _____

Current Zoning: _____ Lot Area Size _____

Setbacks: Front _____ Side _____ Rear _____

Parking Spaces Required: _____ Parking Spaces Provided: _____

Please describe your project and its purpose and intent. You may attach a typed description.

The scope of this project is routine, scheduled maintenance trimming which is completed every 4-5 years, and is required in order to maintain the safety and reliability of Eversource utilities.

Each property owner on these roads will receive a mailed notification 45 days prior to commencement of trimming, and will have the opportunity at this time, to request a consult if they wish to discuss the work or have any concerns.

The specs for trimming are as follows:
15 ft above primary line conductors, 8 ft to the side of primary lines and 10 ft below primary line conductors.

RECEIVED

APR 10 2023

Revision Date 8/31/2011

Canaan Back Road (19)

- ✓ 1. Eileen Williams – P.O Box 536 Barrington
- ✓ 2. Sunny Acres Farm of Barrington – 134 Old Settlers Rd Barrington
3. Robert Deslauriers – 36 Old Settlers Rd Barrington
4. Lindsay Archila & Denise Savoie – 52 Old Settlers Rd Barrington
- ✓ 5. Roger & Carla Williams – 84 Canaan Back Rd Barrington
6. Colin & Eve Williams – 94 Old Settlers Rd Barrington
- ✓ 7. Paul & Linda Morse – 154 Canaan Back Rd Barrington
8. David Pelletier – 15 Old Settlers Rd Barrington
- ✓ 9. Philip & Karen Boodey – 55 Old Settlers Rd Barrington
10. Timothy & Simone Boodey – 97 Old Settlers Rd Barrington
- ✓ 11. Canaan Chapel Association – 55 Old Settlers Rd Barrington
- ✓ 12. Michelle & Scott Pastre – P.O Box 883 Sharon CT 06069
- ✓ 13. Christopher Betjemann – 216 Canaan Back Rd Barrington
- ✓ 14. Norman & Michelle Briere – 242 Canaan Back Rd Barrington
- ✓ 15. Henry Peterman – 252 Canaan Back Rd Barrington
- ✓ 16. Sam & Connie Ronda – 258 Canaan Back Rd Barrington
- ✓ 17. Charles & Judith Griffin – 181 Canaan Back Rd Barrington
- ✓ 18. Peter & Jaqueline Baird – 19 Lupine Ln Barrington
- ✓ 19. Conrad Pszczola (couldn't read the hand writing on the last name) 20 Lupine Ln Barrington
- ✓ 20. Scott & Jodi Zichfelder – 169 Canaan Back Rd Barrington
- ✓ 21. Henry Mikiewicz – P.O Box 700 Barrington
- ✓ 22. Michael & Susan Camire – 237 Canaan Back Rd Barrington
- ✓ 23. Glenn & Sherry Hayes – 249 Canaan Back Rd Barrington
- ✓ 24. Paul & Catherine Klehm – 259 Canaan Back Rd Barrington
25. Vail III & Karen Leach – 177 Old Settlers Rd Barrington
26. Charles & Judith Griffin – 181 Canaan Back Rd Strafford

ABUTTER LIST

Town of Barrington, NH

Please Print or Type

Applicant: Crystal Franciosi on behalf of Eversource Energy Phone 603-831-9806

Project Address: Canaan Back Rd Barrington

List the names and addresses of all parties below. For abutting lot owners, list each owner whose lot adjoins or is directly across the street or a body of water from the subject property. This form may not be completed more than five (5) days prior to the application deadline.

LEGAL OWNER OF SUBJECT LOT

Map	Lot	Zone	Owner Name	Mailing Address

ABUTTING LOT OWNERS

Map	Lot	Owner Name	Owner Mailing Address (NOT property location)
00243	0019	Canaan Chapel Association	55 Old Settlers Rd Barrington NH 03825
00243	0018	Roger & Carla Williams	84 Canaan Back Rd Barrington NH 03822
00243	0020	Michelle & Scott Pastre	PO Box 883 Sherborn CT 06069
00243	0017	Roger & Carla Williams	84 Canaan Back Rd Barrington NH 03822
00243	0016	Roger & Carla Williams	84 Canaan Back Rd Barrington NH 03822
00243	0015	Roger & Carla Williams	84 Canaan Back Rd Barrington NH 03825
00243	0014	Roger & Carla Williams	84 Canaan Back Rd Barrington NH 03825
00244	0039	Roger & Carla Williams	84 Canaan Back Rd Barrington NH 03822
00244	0038	Eileen Williams	PO Box 536 Barrington NH 03825
00244	0023	Linda & Paul Morse	154 Canaan Back Rd Barrington NH 03822

PROFESSIONALS AND EASEMENT HOLDERS. Engineers, Surveyors, Soil Scientists, and Architects whose seal appears or will appear on the plans (other than any agent submitting this application); holders of conservation, preservation, or agricultural easements; and upstream dam owners/NHDES.

Name of Professional or Easement Holder

Mailing Address

I, the undersigned, acknowledge that it is the responsibility of the applicant or his/her agent to fill out this form. I understand that any error or omission could affect the validity of any approval. The names and address listed on this form were obtained from the Town of Barrington Assessing Office

on this date: 4-6-23, This is page 1 of 3 pages.

Applicant or Agent: Crystal Franciosi

Planning Staff Verification: Nannu Niu

Date: 4/10/23

RECEIVED**APR 10 2023****LAND USE OFFICE**

ABUTTING LIST

Crystal Franciosi
on behalf of

Town of Barrington, NH
Please Print or Type

Applicant: Eversource Energy

Phone 603-831-9804

Project Address:

Canaan Back Rd Barrington

List the names and addresses of all parties below. For abutting lot owners, list each owner whose lot adjoins or is directly across the street or a body of water from the subject property. This form may not be completed more than five (5) days prior to the application deadline.

LEGAL OWNER OF SUBJECT LOT

Map	Lot	Zone	Owner Name	Mailing Address

ABUTTING LOT OWNERS

Map	Lot	Owner Name	Owner Mailing Address (NOT property location)
00241	0023	Sunny Acres Farm of Barrington	131 Old Settlers Rd Barrington NH 03825
00244	0021	Christopher Betjemann	216 Canaan Back Rd Barrington NH 03825
00241	0020	Norman & Michelle Briere	242 Canaan Back Rd Barrington NH 03825
00239	0020	Henry Peterman	252 Canaan Back Rd Barrington NH 03825
00239	0025	Sam & Connie Ronda	252 Canaan Back Rd Barrington NH 03825
00239	0024	Charles & Judith Griffin	181 Canaan Back Rd Strafford NH 03824
00243	0013	Philip & Karen Boadey	55 Old Settlers Rd Barrington NH 03825
00244	0015	Peter & Jacqueline Baird	19 Lupine Ln Barrington NH 03825
00244	0015-0025	Conrad Pszczolka	20 Lupine Ln Barrington NH 03825
00244	0016	Scott & Jodi Zickfelder	169 Canaan Back Rd Barrington NH 03825

PROFESSIONALS AND EASEMENT HOLDERS. Engineers, Surveyors, Soil Scientists, and Architects whose seal appears or will appear on the plans (other than any agent submitting this application); holders of conservation, preservation, or agricultural easements; and upstream dam owners/NHDES.

Name of Professional or Easement Holder	Mailing Address

I, the undersigned, acknowledge that it is the responsibility of the applicant or his/her agent to fill out this form. I understand that any error or omission could affect the validity of any approval. The names and address listed on this form were obtained from the Town of Barrington Assessing Office

on this date: 4-6-23. This is page 2 of 3 pages.

Applicant or Agent: Crystal Franciosi

Planning Staff Verification: [Signature]

Date: 4/10/23

RECEIVED

APR 10 2023

Applicant:

Project Address:

Town of Barrington, NH
Please Print or Type
TOWN OF BARRINGTON, NH
Please Print or Type

Phone

LAND USE OFFICE

ABUTTING LIST

Crystal Franciosi Town of Barrington, NH
on behalf of Please Print or Type
Applicant: Eversource Energy

Phone 603-831-9806

Project Address:

Canaan Back Rd Barrington

List the names and addresses of all parties below. For abutting lot owners, list each owner whose lot adjoins or is directly across the street or a body of water from the subject property. This form may not be completed more than five (5) days prior to the application deadline.

LEGAL OWNER OF SUBJECT LOT

Map	Lot	Zone	Owner Name	Mailing Address

ABUTTING LOT OWNERS

Map	Lot	Owner Name	Owner Mailing Address (NOT property location)
00244	0017	Henry Mikiewicz	PO Box 700 Barrington NH 03825
00244	0018	Michael & Susan Camire	237 Canaan Back Rd Barrington NH 03825
00244	0019	Glenn & Sherry Hayes	249 Canaan Back Rd Barrington NH 03825
00244	0001	Paul & Catherine Klehm	259 Canaan Back Rd Barrington NH 03825
00244	0002	Paul & Catherine Klehm	259 Canaan Back Rd Barrington NH 03825

PROFESSIONALS AND EASEMENT HOLDERS. Engineers, Surveyors, Soil Scientists, and Architects whose seal appears or will appear on the plans (other than any agent submitting this application); holders of conservation, preservation, or agricultural easements; and upstream dam owners/NHDES.

Name of Professional or Easement Holder

Mailing Address

I, the undersigned, acknowledge that it is the responsibility of the applicant or his/her agent to fill out this form. I understand that any error or omission could affect the validity of any approval. The names and address listed on this form were obtained from the Town of Barrington Assessing Office

on this date: 4-6-23. This is page 3 of 3 pages.Applicant or Agent: Crystal Franciosi

Planning Staff Verification:

Nanni Hu Date: 4/10/23**RECEIVED**

APR 10 2023

LAND USE OFFICE

RECEIVED
APR 10 2023
LAND USE OFFICE

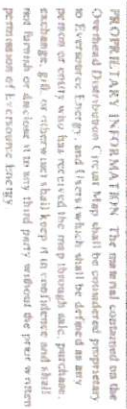

EVERSOURCE

ON Primary: this vessel
 Lateral
 Dislocation
 ON Primary: other vessels
 Lateral
 Dislocation

Primary Margot
 Rupture
 Spont. Rupt.
 Open Rupt.
 Cereb. Aneurysm
 MCTF
 Z2, Z22, Schindler F
 Stress
 Over Inflation
 Strain

Circuit Mileage	
ME TT	0.22
LTT	0.00
ROW	0.26
Not Specified	68.69
Total	69.17

Page:

35 OF 49

U

Location Information
 Circuit: 63W1 65
 Division: NH EASTERN
 District: EPPING

PM10 LCD
20070722

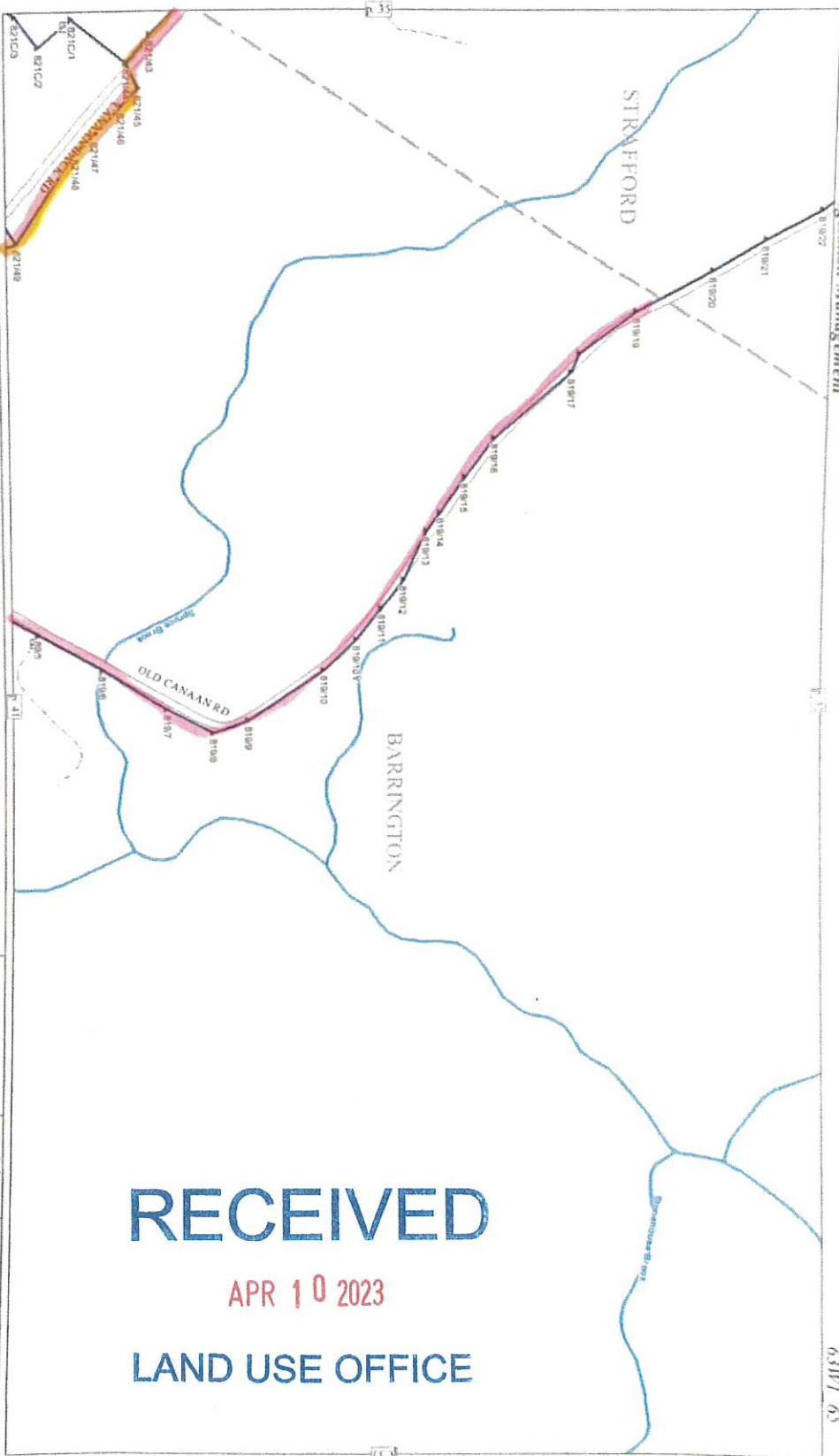

RECEIVED

APR 10 2023

LAND USE OFFICE

EVERSOURCE

PROPRIETARY INFORMATION: The material contained on the Overhead Distribution Circuit Map shall be considered proprietary to Eversource Energy, and Users (which shall be defined as any person or entity who has received the map through sale, purchase, exchange, gift, or otherwise) shall keep it in confidence and shall not furnish or disclose it to any third party without the prior written permission of Eversource Energy.

- OH Primary: this circuit**
- Label
 - Backbone
 - OH Primary: other circuits
 - Substation
 - Poles
 - Switch Bank
 - Open Point
 - Right of Way
 - MTT
 - Schedule ETT
 - Stake
 - From Boundaries

Circuit Mileage

MET	0.22
ETT	0.00
ROW	0.26
Not Specified	68.69
Total	69.17

U

Page: 36 of 49

Location Information
 Circuit: 63W1.65
 Division: NH EASTERN
 District: EPPING

Printed: 2/22/2022



APR 10 2023

LAND USE OFFICE

Location Information

PROPRIETARY INFORMATION. The material contained on the Overhead Distribution Circuit Map shall be considered proprietary to EverSource Energy, and Users (which shall be defined as any person or entity who has received the map through sale, purchase, exchange, gift or otherwise) shall keep it in confidence and shall not furnish or disclose it to any third party without the prior written permission of EverSource Energy.

Circuit: 63W1_65
Division: NH EASTERN
District: EPPING

Plotted
2/22/2022

Circuit Mileage	
METT	0.22
ETT	0.00
ROW	0.26
Not Specified	68.69
Total	69.17

Page:
46 of 49

25. J4J

NO POSTAGE
NECESSARY
IF MAILED
IN THE
UNITED STATES

BUSINESS REPLY MAIL
FIRST CLASS MAIL PERMIT NO. 1027 MANCHESTER NH

POSTAGE WILL BE PAID BY ADDRESSEE
EVERSOURCE
VEGETATION MANAGEMENT
PO BOX 330
MANCHESTER NH 03105-9989

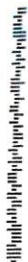

Slow growing trees are **pruned**. Fast growing trees are **removed**.

Because some trees grow quite rapidly, they pose a constant danger around power lines. To eliminate this danger, the trees must be removed.

Slow growing trees include:
Cedar, Hemlock, Hickory, Norway Maple, Oak, Sugar Maple, and certain other species.

Fast growing trees include:
Ash, Birch, Cherry, Pine, Poplar, Red Maple, Silver Maple, Willow, and certain other species.

Pruning pole-to-house lines

Eversource only prunes the line attached from your home to the pole on the street when trees or branches are directly in contact with the wires. Professional tree pruning contractors can be hired by customers for pruning work near these lines.

Eversource may de-energize pole-to-house lines for professional tree contractors so they can prune trees safely. Please call Eversource at 1-800-662-7764 for more information.



Help us keep you **safe**.

If a tree branch breaks off and lands on a power line, don't touch the branch or wire. Call Eversource immediately at 1-800-662-7764.

- Don't cut down trees or branches near power lines yourself. Have it done by trained professionals or call Eversource.
- Stay clear of power lines when removing any object caught in a tree.
- No one should climb trees that are anywhere near power lines. Be sure that children understand this.
- Before you plant a tree, make sure it won't grow too close to overhead power lines when it matures.

Remember, the electric lines running from the utility pole to your house are energized and can be dangerous. Don't go near these lines or attempt to prune trees or branches around them!

If you have any questions or would like more information, you can always call Eversource at 1-800-662-7764, or visit us on the web at Eversource.com.

EVERSOURCE

To improve service, Eversource is
**Pruning Trees in
your neighborhood.**



EVERSOURCE

RECEIVED

APR 10 2023

LAND USE OFFICE



You can help.

Regular tree pruning helps to prevent power outages and means less safety hazards for you.

Put some things together and they just don't mix. Take trees and power lines. They can live mere feet from each other in perfect harmony. But when they touch, it can cause everything from power outages, fires, and downed lines, to safety hazards for people, wildlife, and even the trees themselves.

To help keep power lines safe, Eversource has trees pruned on a regular, rotating schedule. During this time, branches are cleared or certain trees are removed from around power lines before they have a chance to damage property, cause outages, or compromise safety.

Before this work is performed, your consent is needed.

To help ensure public safety and minimize power outages in your neighborhood, Eversource has hired a professional tree pruning company to prune the trees and brush in your area. Pruning is one of the most important means of maintaining and improving tree health and doesn't harm trees when proper arboricultural techniques are followed.

And because keeping power lines safe is our responsibility, there is no cost to you. However, before starting work, our contractor requests your consent.

When the tree pruning company arrives, they will prune to create the following minimum safe distances between the electrical lines and the surrounding trees:

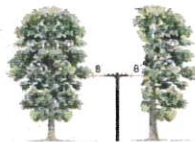

Any limb extending within 8 feet of the electrical line will be cut back. Because proper pruning requires cutting at certain points, branches will be cut at a main branching point, or at the trunk, leaving no stub. Sometimes this may mean the branch is cut more than 8 feet from the wires, but it helps preserve the health of the tree. Trees 16 inches in diameter or less at chest height located less than 8 feet from the nearest wire may be removed.



Any limb above the wire to a height of 15 feet will be removed. Certain main branches on older trees can remain inside of the minimum clearance, but this depends on the health of the tree, direction of growth, and likelihood of its limbs reaching the wires.

Species located under the line and recognized as fast growing will be removed. Slower growing species will be left if they have a minimum of 10 feet of clearance to the nearest primary conductor.

Giving consent is easy.

Please read through this brochure and fill out the consent form to the right. Tear along the green dotted line. Masten glue, fold in half, seal and mail this postage-paid card.

Your response is important.

For those who don't respond promptly, a contractor representative may call to get your consent before work begins. If you do not respond within 45 days, you are presumed to have consented.

Your assigned contractor

Please check the following:

- ☐ **Yes!** Your contractor has my consent to prune or remove trees to minimize outages and maintain required clearance at power lines.
☐ **I request a personal consultation before pruning begins.**
☐ **Yes! Please remove the wood.**
☐ **I do own this property.** (Please sign and date below)

Best time to call: _____

Name: _____
 Address: _____
 Signature and Date: _____

Phone: _____

Please cut this card on the green dotted line. Then my "yes" will be sent to Eversource.

RECEIVED
 APR 10 2023
 LAND USE OFFICE